

27W / 1840lm / 2700K / On/Off / Flood 52° /  
1200mm

60940

Design: O/M + Bartenbach GmbH  
inVision module with housing and perforated cover  
plate made of aluminium with textured-paint finish.

LED CRI>90 / >50.000h, L80/B10 / 2-step MacAdam  
Power supply included.  
IP20 | 230Vac | 50/60Hz



- Structure**
  - 1 Profile
  - 2 End caps
  - 3 Fitting accessories
  - 4 Profile coupling
- Modules**
  - A inVision Module

| LED        | 2700K | Light Source | Luminaire |
|------------|-------|--------------|-----------|
| Power      |       | 27W          | 32,9W     |
| Flux       |       | 2400lm       | 1840lm    |
| Efficiency |       | 89lm/W       | 56lm/W    |
| LOR        |       | -            | 77%       |
| UGR        |       | -            | <13       |



Beam angle  
Flood 52°

Application



Weight  
0,8Kg

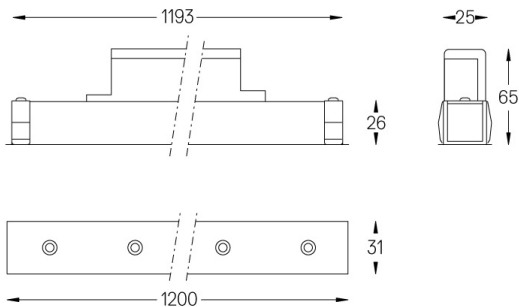

#### Finishes

- .01 White / RAL 9010
- .02 Black / RAL 9005

Choose the length and layout of the system exactly as you want it, to  
model the right lighting functions for different tasks. For further  
information please contact: [support@om-light.com](mailto:support@om-light.com)