

46W\* / 2840lm\* / 2200K-5000K / On/Off /  
Flood 52° / 1200mm

61300



#### Structure

- 1 Profile
- 2 End caps
- 3 Fitting accessories
- 4 Profile coupling

#### Modules

A inVision Module

Design: O/M + Bartenbach GmbH

inVision module with housing and perforated cover plate made of aluminium with textured-paint finish.  
2200-5000K Tunable White

LED CRI>80 / >50.000h, L80/B10 / 3-step MacAdam  
Power supply included.  
DALI DT8.  
IP20 | 230Vac | 50/60Hz



LED	2200K-5000K	Light Source	Luminaire
Power		46W*	54,1W*
Flux		3760lm*	2840lm*
Efficiency		82lm/W	52lm/W
LOR		-	76%
UGR		-	<16



Beam angle  
Flood 52°

#### Application



Weight  
0,6Kg

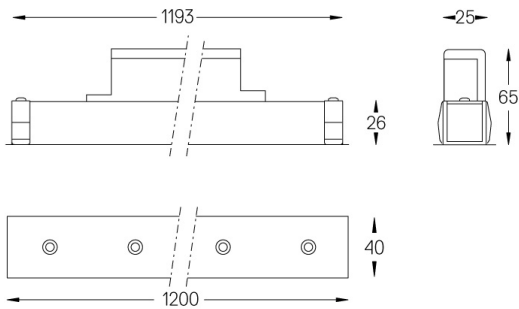

#### Finishes

- .01 White / RAL 9010
- .02 Black / RAL 9005

Choose the length and layout of the system exactly as you want it, to model the right lighting functions for different tasks. For further information please contact: [support@om-light.com](mailto:support@om-light.com)