

5,6W / 215lm / 4000K / On/Off / Spot 15° /
ø45mm

64470



Design: O/M + Bartenbach GmbH

Recessed spotlight with die-cast aluminium body
with electrostatic 100% polyester paint finish.Spot-lens with individual complex surface rips to
provide a focal light and an extremely narrow beam.Orientable by 150° horizontal rotation and 330°
vertical rotation.

Driver included.

LED CRI>90 / >50.000h, L80/B10
2-step MacAdam / Driver included.
IP20 | 230Vac | 50/60Hz

LED	4000K	Light Source	Luminaire
Power		5,6W	7W
Flux		480lm	215lm
Efficiency		86lm/W	31lm/W
LOR		-	45%
Operating Condition		-	230Vac

Beam angle
Spot 15°

Application

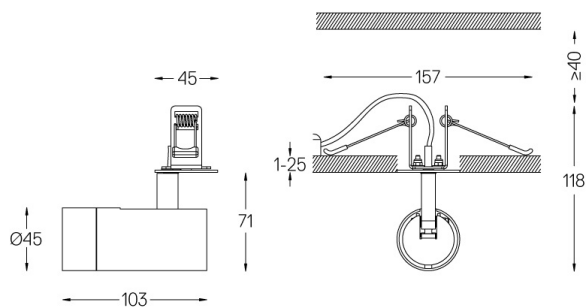
Weight
0,27Kg

Finishes

- .01 White / RAL 9010
- .02 Black / RAL 9005

Optional

59072 1/4 CTO

ø35x1,1mm

59073 1/2 CTO

ø35x1,1mm

59074 Louvre

ø35x2mm

59075 Soft diffuser

ø35x2mm

The cutout dimensions are for plasterboard ceilings. For other type of
material please contact: support@om-light.com