

52W / 3640lm / 2700K / On/Off / Flood 52°
/ 1200mm

61264

Design: O/M + Bartenbach GmbH
Módulo inVision em alumínio com face metálica
perfurada e acabamento com pintura texturada.

LED CRI>90 / >50.000h, L80/B10 / 2-step MacAdam
Fonte de alimentação incluída.
IP20 | 230Vac | 50/60Hz

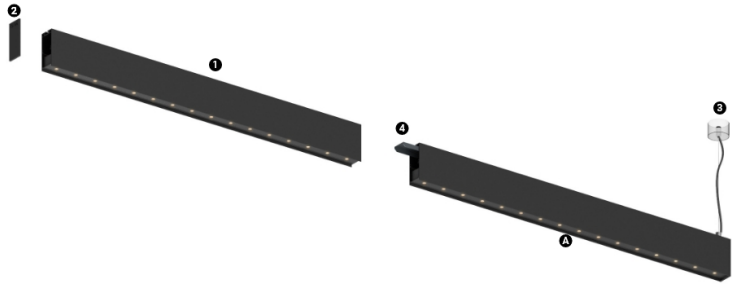

Structure

- 1 Profile
- 2 End caps
- 3 Fitting accessories
- 4 Profile coupling

Modules

- A inVision Module

LED	2700K	Fonte de Luz	Luminária
Potência		52W	61,2W
Fluxo		4800lm	3640lm
Eficiência		92lm/W	60lm/W
LOR		-	76%
UGR		-	<16



Ângulo de abertura
Flood 52°

Aplicação



Peso
0,6Kg

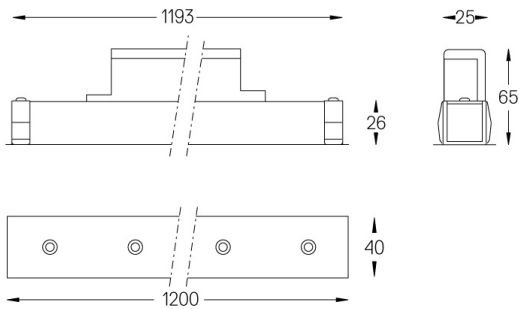

Acabamentos

- .01 Branco / RAL 9010
- .02 Preto / RAL 9005

Choose the length and layout of the system exactly as you want it, to
model the right lighting functions for different tasks. For further
information please contact: support@om-light.com